

Installing Faux Panels on Concrete (Glue Only)

The following are directions on how to install Faux Panels on Concrete (glue only)



1. Besides the standard tools needed for installation, you will also need a can(s) of Great Stuff Gaps & Cracks



2. Dry fit the panels and mark on the wall where they belong.

Hint: Proper placement of the first panel to be installed is crucial since once the glue sets, there is no moving it. and the glue sets in minutes.



3. Use a stiff bristle brush to clean off the cement wall to make sure it is free of dirt and loose cement.



4. Follow all directions and warnings that are on the can of Great Stuff. Wear gloves to avoid getting the Great Stuff on your hands.

Hint: Great Stuff sticks to stuff great! If you get it on your hands it will be there for a long time. wear gloves!



5. Apply a bead of Great Stuff to the back of the panel in a zig zag pattern. keep moving fast. It doesn't require a large amount. The Great Stuff expands as it cures

Hint: Avoid applying it to close to the edges of the panels to avoid having it expand and squeeze out of the seams.



6. Quickly place that first panel on the wall where your marks are. Use a slight wiggle motion to insure a good bond between the panel, glue and cement. Apply firm pressure against the panel for a few minutes until the glue dries.



7. Working off that first panel, prepare for the next panel to be installed. Dry fit it first. Make any necessary cuts.



8. Apply our Industrial Strength or PL premium construction adhesive to the edges of the panels that will be joint together.

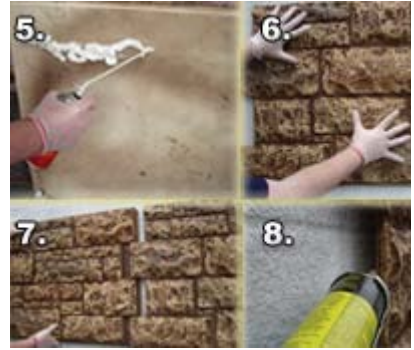

9. Repeat steps 5-8 as necessary to complete your project.



10. Caulk all seams for a weather tight seal. If necessary, use touch up paint on the caulk when it is dry to insure a good color match.

MAKE SURE to observe and obey all safety rules and recommendations set forth by tool manufacturers and local, state, and federal authorities for any building project including all applicable building codes.